

Mayflower Close Garages Mayflower Close, Dartmouth, Auction Guide Price +++ £95,000

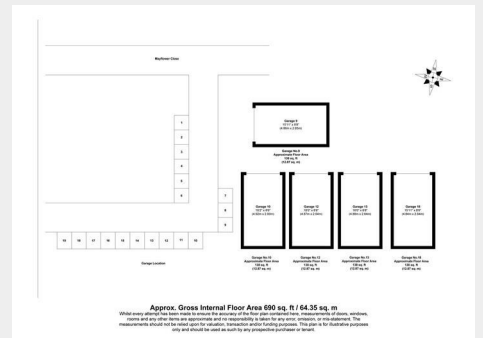

- FOR SALE BY ONLINE AUCTION
- WEDNESDAY 23rd JULY 2025
- VIRTUAL TOUR NOW ONLINE
- VIEWINGS – REFER TO DETAILS
- LEGAL PACK COMPLETE
- JULY LIVE ONLINE AUCTION
- FREEHOLD GARAGES
- PORTFOLIO OF 5 SINGLE UNITS
- VACANT | UP & OVER DOOR
- EXTENDED 6 WEEK COMPLETION

Hollis Morgan – JULY LIVE ONLINE AUCTION – A Freehold PORTFOLIO OF 5 X SINGLE GARAGES set within a private courtyard | Vacant Possession

Mayflower Close Garages Mayflower Close, Dartmouth, Devon, TQ6 9JN

Accommodation

FOR SALE BY LIVE ONLINE AUCTION

ADDRESS | Garages 9, 10, 12, 13, 18 - Mayflower Close Mayflower Close Garages, Dartmouth TQ6 9JN

Lot Number 72

The Live Online Auction is on Wednesday 23rd July 2025 @ 17:30
Registration Deadline is on Monday 21st July 2025 @ 16:00

The Auction will be streamed LIVE ONLINE via the Hollis Morgan website & you can chose to bid by telephone, proxy or via your computer. Registration is a simple online process – please visit the Hollis Morgan auction website and click “REGISTER TO BID”

THE GARAGES

A Freehold portfolio of 5 single garages with up and over doors set within a courtyard of similar units with vehicular access from Mayflower Close. Sold with vacant possession.

Tenure - Freehold

THE OPPORTUNITY

GARAGES FOR OWNER OCCUPIER | INVESTMENT

The garages are located in an area where pressure on both parking and storage are at an absolute premium.

LOCATION

Dartmouth is situated at the mouth of the River Dart and is one of South Devon's most popular and enchanting towns with its charming historic streets, scenic river location and surrounding rolling countryside. This pretty and popular waterside town offers an abundance of boutiques, galleries, pubs and restaurants and benefits from a medical centre, cinema, library, two swimming pools, a leisure centre, three supermarkets and is home to the Britannia Royal Naval College. Throughout the year, the town hosts a number of fabulous events and festivals, including the Dartmouth Music Festival, The Port of Dartmouth Royal Regatta and Dartmouth Food Festival. The town's deep-water port attracts sailing vessels from all over the world and is only a short drive from some of the most beautiful beaches in the area. The A38 Devon expressway is approximately 19 miles away, allowing speedy access to the cities of Exeter and Plymouth and the country beyond whilst main line rail links to London Paddington can be made in Totnes.

SOLICITORS & COMPLETION

Elspeth Ayling
Capsticks
0196 267 8348
elspeth.ayling@capsticks.com
www.capsticks.com/

EXTENDED COMPLETION

Completion is set for 6 weeks or earlier subject to mutual consent.

Floor plan

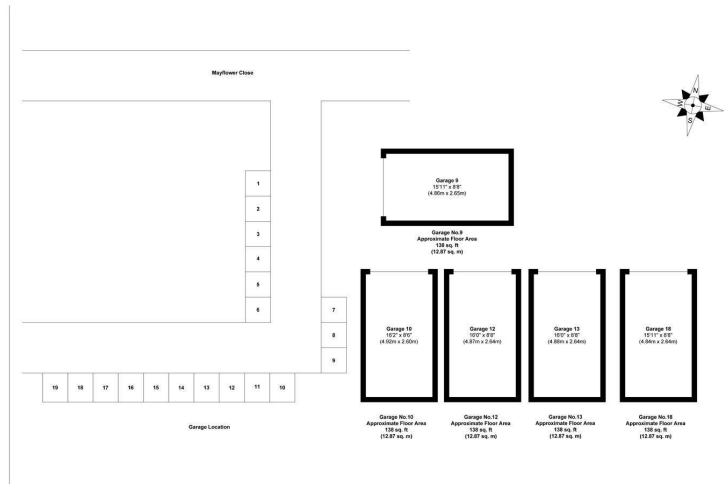

Approx. Gross Internal Floor Area 690 sq. ft / 64.35 sq. m

Whilst every attempt has been made to ensure the accuracy of the floor plan contained herein, measurements of doors, windows, rooms and any other items are approximate and no responsibility is taken for any error, omission, or mis-statement. The measurements should not be relied upon for valuation, transaction and/or funding purposes. This plan is for illustrative purposes only and should be used as such by any prospective purchaser or tenant.

EPC Chart

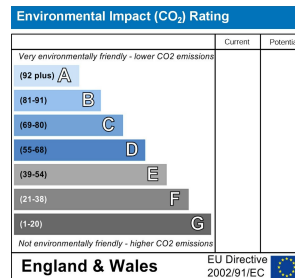
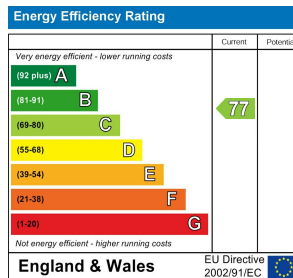

9 Waterloo Street
Clifton
Bristol
BS8 4BT

**hollis
morgan**

Tel: 0117 973 6565
Email: post@hollismorgan.co.uk
www.hollismorgan.co.uk

Hollis Morgan Property Limited, registered in England, registered 7275716.
Registered address, 5 Upper Belgrave Road, Clifton, Bristol BS8 2XQ

Auction Property Details Disclaimer

Hollis Morgan endeavour to make our sales details clear, accurate and reliable in line with the Consumer Protection from Unfair Trading Regulations 2008 but they should not be relied on as statements or representations of fact.

Please refer to our website for further details.